



Joint RTJ "BX"

(Dimension en mm)

RTJ Gasket "BX"

(size in mm)

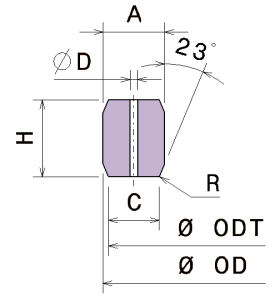

ASME B16-20 (2)

N°	ØOD 0 -0.15	ØODT +0.05	A +0.2 0	C +0.15 0	H +0.2 0	ØD +0.5	Poids Weight (Kg)
BX150	72.19	70.87	9.3	7.98	9.3	1.5	0.132
BX151	76.4	75.03	9.63	8.26	9.63	1.5	0.15
BX152	84.68	83.24	10.24	8.79	10.24	1.5	0.189
BX153	100.94	99.31	11.38	9.78	11.38	1.5	0.281
BX154	116.84	115.09	12.4	10.64	12.4	1.5	0.389
BX155	147.96	145.95	14.22	12.22	14.22	1.5	0.656
BX156	237.92	235.28	18.62	15.98	18.62	3	1.842
BX157	294.46	291.49	20.98	18.01	20.98	3	2.917
BX158	352.04	348.77	23.14	19.86	23.14	3	4.267
BX159	426.72	423.09	25.7	22.07	25.7	3	6.419
BX160	402.59	399.21	13.74	10.36	23.83	3	3.03
BX161	491.41	487.45	16.21	12.24	28.07	3	5.147
BX162	475.49	473.48	14.22	12.22	14.22	1.5	2.261
BX163	556.16	551.89	17.37	13.11	30.1	3	6.706
BX164	570.56	566.29	24.59	20.32	30.1	3	9.738
BX165	624.71	620.19	18.49	13.97	32.03	3	8.548
BX166	640.03	635.51	26.14	21.62	32.03	3	12.39
BX167	759.36	754.28	13.11	8.03	35.86	1.5	8.144
BX168	765.25	760.17	16.05	10.97	35.86	1.5	10.137
BX169	173.51	171.27	12.93	10.69	15.85	1.5	0.793
BX170	218.03	216.03	14.22	12.22	14.22	1.5	0.999
BX171	267.44	265.43	14.22	12.22	14.22	1.5	1.241
BX172	333.07	331.06	14.22	12.22	14.22	1.5	1.563
BX303	852.75	847.37	16.97	11.61	37.95	1.5	12.881

API 6A (1)

N°	ØOD 0 -0.15	ØODT +0.05	A +0.2 0	C +0.15 0	H +0.2 0	ØD +0.5	Poids Weight (Kg)
BX150	72.19	70.87	8.74	4.62	3.18	19.05	0.132
BX151	76.4	75.03	11.91	6.45	4.24	25.4	0.15
BX152	84.68	83.24	11.91	6.45	4.24	25.4	0.189
BX153	100.94	99.31	8.74	4.62	3.18	19.05	0.281
BX154	116.84	115.09	11.91	6.45	4.24	25.4	0.389
BX155	147.96	145.95	11.91	6.45	4.24	25.4	0.656
BX156	237.92	235.28	11.91	6.45	4.24	25.4	1.842
BX157	294.46	291.49	11.91	6.45	4.24	25.4	2.917
BX158	352.04	348.77	11.91	6.45	4.24	25.4	4.267
BX159	426.72	423.09	11.91	6.45	4.24	25.4	6.419
BX160	402.59	399.21	11.91	6.45	4.24	25.4	3.03
BX161	491.41	487.45	11.91	6.45	4.24	25.4	5.147
BX162	475.49	473.48	11.91	6.45	4.24	25.4	2.261
BX163	556.16	551.89	13.49	6.68	4.78	28.58	6.706
BX164	570.56	566.29	19.84	10.34	6.88	41.28	9.738
BX165	624.71	620.19	11.91	6.45	4.24	25.4	8.548
BX166	640.03	635.51	16.66	8.51	5.28	31.75	12.39
BX167	759.36	754.28	11.91	6.45	4.24	25.4	8.144
BX168	765.25	760.17	16.66	8.51	5.28	31.75	10.137
BX169	173.51	171.27	11.91	6.45	4.24	25.4	0.793
BX170	218.03	216.03	27	14.78	8.46	50.8	0.999
BX171	267.44	265.43	11.91	6.45	4.24	25.4	1.241
BX172	333.07	331.06	16.66	8.51	5.28	31.75	1.563
BX303	852.75	847.37	11.91	6.45	4.24	25.4	12.881

NOTA:

- (1) : la plus restrictive des normes pour les joint RTJ puisqu'il est obligatoire que le fabricant soit agréé API 6.

Les joints doivent être monogrammé du logo API suivi du numéro d'agrément du fabricant (pour SPM: 6A0200).

- (2) : Norme la plus courante et la moins restrictive.

NOTE:

- (1) : The most restrictive standards for RTJ gasket. It is required that the manufacturer is authorized API 6 .

The gaskets must be monogrammed logo follow the API manufacturer approval number (for SPM : 6A0200) .

- (2) : Standard most common and least restrictive.